

The ICFLC and ICFVL-CW ledger connector system is engineered to solve the challenges of mounting steel or wood ledgers on insulated concrete walls. The ledger connector system is easy, quick and versatile to use. The perforations in the embedded leg of the ICFLC permit the concrete to flow around it, anchoring the ICFLC securely within the wall. The exposed flange provides a structural surface for mounting either a wood or a steel ledger.

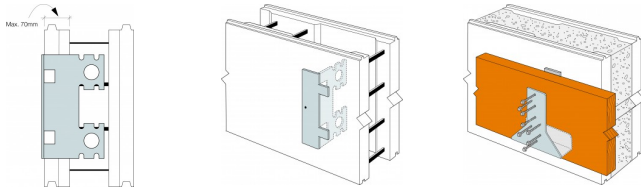

APPLICATIONS

Notes

1. Spacings shown apply to vertical loads only.
2. No load duration increase is allowed.
3. Minimum concrete grade C20/25.
4. Do not splice ledger at ICFLC location.

WARNING: Industry studies show that hardened fasteners can experience performance problems in wet environments. Accordingly, use this product in dry, interior applications only.

TECHNICAL DATA

Solid Sawn Ledger - ICF with ICFVL-CW (67mm forms)

References	Timber ledge support	Download per ICF Connector	Max. connector spacing
ICFLC	ICFVL-CW	8.5	1200

For solid sawn ledger, use 8 No D3 screws provided. Min C16 Ledger.

Steel Ledger - ICFLC with 67mm form

References	Download per ICF Connector	Steel ledger thickness	Connector Spacing
ICFLC	8.5	1.6	350

Steel Ledger - ICFLC with 67mm form.

Steel Ledger - ICFLC with 70mm form

References	Download per ICF Connector	Steel ledger thickness	Connector Spacing
ICFLC	7.8	1.6	350

1. Minimum steel ledger specification is A-653 SS Grade 50.
2. Use three 1/4-14x3/4", #3 drill point screws (not provided).
3. Minimum screw shear capacity is 3.3kN.

