

LSSU is an innovative hanger that allows you to adjust the skew and slope necessary for its installation up to 45° in the 4 directions on site.



[ETA-08/0053](#), [UK-DoP-e08/0053](#)

## FEATURES



## Material

- Galvanized steel S250GD + Z275 according to NF EN 10346 or G90 according to ASTM A653.
- Thickness: **LSSU** - 1.2mm - 1.5mm - 1.6mm / **LSU** - 2mm.

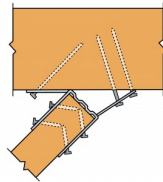
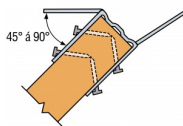
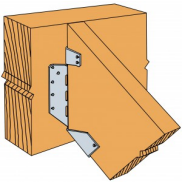

## APPLICATIONS

### Suitable On

- **Supporting member:** solid wood, composite lumber, glued-laminated wood, etc.
- **Supported member:** I-beams, solid wood, composites, etc.

### When to Use

- Fastening of rafters.
- Principal rafters.
- Headers, etc.

TECHNICAL DATA

Product Dimensions

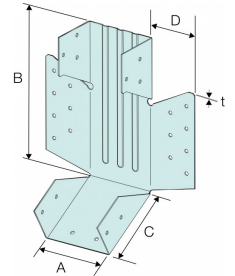
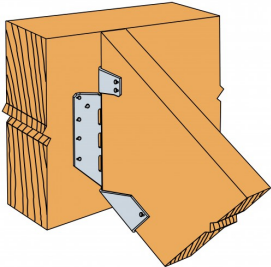

References	Product Dimensions [mm]					Header holes	Joist holes
	A	B	C	D	t	Ø4x6	Ø4x6
LSSU28	38	181	89	44	1.2	10	5
LSSU210	38	216	89	44	1.2	10	7
LSSU25	45	216	89	44	1.2	10	7
LSSU35	60	216	89	50	1.2	10	7
LSSU275/66	66	275	90	58	1.5	18	11
LSSU275/71	71	275	90	65	1.5	18	11
LSSU210-2	78	216	89	75	1.6	18	12
LSSU410	90	216	89	69	1.6	18	12
LSU3510-2	120	229	89	89	2	24	16
LSU26	38	102	80	38	1.2	6	5
LSSU170/50	50	170	90	58	1.2	10	11
LSSU275/50	50	275	90	58	1.2	18	11
LSSU12.06	52	216	89	47	1.2	10	7
LSSU170/66	66	170	90	58	1.2	10	11
LSSU170/71	71	170	90	65	1.2	10	11
LSSU170/75	75	170	90	65	1.2	14	12
LSSU275/75	75	275	90	65	1.2	18	12
LSSU170/96	96	170	90	80	1.2	14	11
LSSU275/96	96	275	90	80	1.2	18	11
LSSU170/100	100	170	90	80	1.2	14	11
LSSU275/100	100	275	90	80	1.2	18	11
LSU4.12*	105	229	89	59	1.2	24	12

\* Bending in slope only  
SCL: Structural Composite Lumber

Product capacities - Timber to timber -sloped only

References	Joist Size [mm]				Number of Fasteners				Characteristic Capacities [kN]						Safe Workings Loads [kN]								
	Width		Height		Header		Joist		R <sub>1,k</sub>			R <sub>2,k</sub>			R <sub>1,SWL,Long term</sub>			R <sub>1,SWL,Medium Term</sub>			Short Term Uplift		
	Min	Max.	Min	Max.	Qty	Type	Qty	Type	I-joist LVL flange	I-joist Solid section	Solid Timber C24	I-joist LVL flange	I-joist Solid section	Solid Timber C24	I-joist LVL flange	I-joist Solid section	Solid Timber C24	I-joist LVL flange	I-joist Solid section	Solid Timber C24	I-joist LVL flange	I-joist Solid section	Solid Timber C24
LSSU28	36	38	241	241	10	3.75 x 75	5	3.75 x 30	5.1	7.3	7.3	2.4	2.4	2.4	2.1	3	3	2.4	3.5	3.5	1.2	1.2	1.2

References	Joist Size [mm]				Number of Fasteners				Characteristic Capacities [kN]						Safe Workings Loads [kN]								
	Width		Height		Header		Joist		R <sub>1,k</sub>			R <sub>2,k</sub>			R <sub>1,SWL,Long term</sub>			R <sub>1,SWL,Medium Term</sub>			Short Term Uplift		
	Min	Max.	Min	Max.	Qty	Type	Qty	Type	I-joist LVL flange	I-joist Solid section	Solid Timber C24	I-joist LVL flange	I-joist Solid section	Solid Timber C24	I-joist LVL flange	I-joist Solid section	Solid Timber C24	I-joist LVL flange	I-joist Solid section	Solid Timber C24	I-joist LVL flange	I-joist Solid section	Solid Timber C24
LSSU210	36	38	302	302	10	3.75 x 75	7	3.75 x 30	5.1	7.3	7.3	2.4	2.4	2.4	2.1	3	3	2.4	3.5	3.5	1.2	1.2	1.2
LSSUI25	43	45	241	356	10	3.75 x 75	7	3.75 x 30	5.1	9.9	9.9	2.4	4	4	2.1	3	3	2.4	3.5	3.5	1.2	1.2	1.2
LSSUI35	56	58	241	356	10	3.75 x 75	7	3.75 x 30	9.1	9.9	9.9	2.4	4	4	2.1	4.1	4.1	2.4	4.7	4.7	1.2	2	2
LSSU275/66	61	63	300	450	18	3.75 x 75	11	3.75 x 30	-	10.6	10.6	-	5.7	5.7	-	4.4	4.4	-	5	5	-	2.9	2.9
LSSU275/71	68	70	300	450	18	3.75 x 75	11	3.75 x 30	9.1	10.6	10.6	2.4	5.7	5.7	3.8	4.4	4.4	4.4	5	5	1.2	2.9	2.9
LSSU210-2	-	2x38	241	-	18	4.0 x 100	12	3.75 x 30	9.1	-	-	2.4	-	-	3.8	-	-	4.4	-	-	1.2	-	-
LSSU410	87	89	241	356	18	4.0 x 100	12	3.75 x 30	11.2	12.4	12.4	3	2.3	2.3	4.6	5.2	5.2	5.3	5.9	5.9	1.5	2.4	2.4
LSU3510-2	-	2x58	241	356	24	4.0 x 100	12	3.75 x 30	15.2	12.6	12.6	3.7	4.6	4.6	6.3	5.2	5.2	7.2	6	6	3	2.3	2.3
LSU26	36	38	150	-	6	3.75 x 75	5	3.75 x 30	6.8	7.3	7.3	2.6	2.6	2.6	2.8	3	3	3.2	3.5	3.5	1.3	1.3	1.3
LSSU170/50	45	47	195	245	10	3.75 x 75	11	3.75 x 30	-	11.4	11.4	-	5.7	5.7	-	4.7	4.7	-	5.4	5.4	-	2.9	2.9
LSSU275/50	45	47	300	450	18	3.75 x 75	11	3.75 x 30	-	10.6	10.6	-	5.7	5.7	-	4.4	4.4	-	5	5	-	2.9	2.9
LSSUI2.06	49	51	241	356	10	3.75 x 75	7	3.75 x 30	5.1	-	-	2.4	-	-	2.1	-	-	2.4	-	-	1.2	-	-
LSSU170/66	61	63	195	245	10	3.75 x 75	11	3.75 x 30	-	11.4	11.4	-	5.7	5.7	-	4.7	4.7	-	5.4	5.4	-	2.9	2.9
LSSU170/71	68	70	195	300	10	3.75 x 75	11	3.75 x 30	9.1	11.4	11.4	2.4	5.7	5.7	3.8	4.7	4.7	4.4	5.4	5.4	1.2	2.9	2.9
LSSU170/75	70	72	195	300	14	3.75 x 75	12	3.75 x 30	-	11.4	11.4	-	5.7	5.7	-	4.7	4.7	-	5.4	5.4	-	2.9	2.9
LSSU275/75	70	72	300	400	18	3.75 x 75	12	3.75 x 30	-	10.6	10.6	-	5.7	5.7	-	4.4	4.4	-	5	5	-	2.9	2.9
LSSU170/96	-	2x47	195	300	14	3.75 x 75	11	3.75 x 30	-	11.4	11.4	-	5.7	5.7	-	4.7	4.7	-	5.4	5.4	-	2.9	2.9
LSSU275/96	-	2x47	300	450	18	3.75 x 75	11	3.75 x 30	-	10.6	10.6	-	5.7	5.7	-	4.4	4.4	-	5	5	-	2.9	2.9
LSSU170/100	95	97	195	300	14	3.75 x 75	11	3.75 x 30	-	13.1	13.1	-	5.7	5.7	-	5.5	5.5	-	6.2	6.2	-	2.9	2.9
LSSU275/100	95	97	300	400	18	3.75 x 75	11	3.75 x 30	-	14.3	14.3	-	5.7	5.7	-	6	6	-	6.8	6.8	-	2.9	2.9
LSU4.12*	-	2x51	241	356	24	4.0 x 100	12	3.75 x 30	11.2	-	-	3	-	-	4.6	-	-	5.3	-	-	3	-	-

Product capacities - Timber to timber - skewed or sloped & skewed

References	Joist Size [mm]				Number of Fasteners				Characteristic Capacities [kN]						Safe Working Loads [kN]								
	Width		Height		Header		Joist		R <sub>1,k</sub>			R <sub>2,k</sub>			R <sub>1,SWL,LongTerm</sub>			R <sub>1,SWL,MediumTerm</sub>			R <sub>2,SWL,ShortTerm</sub>		
	Min	Max.	Min	Max.	Qty	Type	Qty	Type	I-joist LVL flange	I-joist Solid section	Solid Timber C24	I-joist LVL flange	I-joist Solid section	Solid Timber C24	I-joist LVL flange	I-joist Solid section	Solid Timber C24	I-joist LVL flange	I-joist Solid section	Solid Timber C24	I-joist LVL flange	I-joist Solid section	Solid Timber C24
LSSU28	36	38	241	241	9	3.75 x 75	5	3.75 x 30	3.4	3.2	3.2	1.5	1.5	1.5	1.4	1.4	1.4	1.6	1.5	1.5	0.7	1.2	1.2
LSSU210	36	38	302	302	9	3.75 x 75	7	3.75 x 30	3.4	3.2	3.2	1.5	1.5	1.5	1.4	1.4	1.4	1.6	1.5	1.5	0.7	1.2	1.2
LSSU125	43	45	241	356	9	3.75 x 75	7	3.75 x 30	3.4	8.1	8.1	1.5	4	4	1.4	3.4	3.4	1.6	3.9	3.9	0.7	1.2	1.2
LSSU135	56	58	241	356	9	3.75 x 75	7	3.75 x 30	6.8	8.1	8.1	6.6	4	4	1.4	3.4	3.4	1.6	3.9	3.9	0.7	2	2
LSSU275/66	61	63	300	450	15	3.75 x 75	11	3.75 x 30	-	10.8	10.8	-	5.7	5.7	-	4.5	4.5	-	5.1	5.1	-	2.9	2.9
LSSU275/71	68	70	300	450	15	3.75 x 75	11	3.75 x 30	6.8	10.8	10.8	2.4	5.7	5.7	2.8	2.6	2.6	3.2	3	3	1.2	2.9	2.9
LSSU210-2	-	2x38	241	-	14	4.0 x 100	12	3.75 x 30	6.8	-	-	2.4	-	-	2.8	-	-	3.2	-	-	1.2	-	-
LSSU410	87	89	241	356	14	4.0 x 100	12	3.75 x 30	7.2	7.1	7.1	3	2.3	2.3	3	3	3	3.4	3.4	3.4	1.5	2.4	2.4
LSU3510-2	-	2x58	241	356	24	4.0 x 100	12	3.75 x 30	11.1	11.9	11.9	3.7	4.6	4.6	4.6	5	5	5.3	5.7	5.7	1.8	2.3	2.3
LSU26	36	38	150	-	-	-	-	-	4.2	3.2	3.2	2.6	2.6	2.6	-	-	-	-	-	-	-	-	-
LSSU170/50	45	47	195	245	9	3.75 x 75	11	3.75 x 30	-	6.3	6.3	-	5.7	5.7	-	2.6	2.6	-	3	3	-	2.9	2.9
LSSU275/50	45	47	300	450	15	3.75 x 75	11	3.75 x 30	-	10.8	10.8	-	5.7	5.7	-	4.5	4.5	-	5.1	5.1	-	2.9	2.9
LSSU12.06	49	51	241	356	9	3.75 x 75	7	3.75 x 30	3.4	-	-	1.5	-	-	1.4	-	-	1.6	-	-	0.7	-	-
LSSU170/66	61	63	195	245	9	3.75 x 75	11	3.75 x 30	-	6.3	6.3	-	5.7	5.7	-	2.6	2.6	-	3	3	-	2.9	2.9
LSSU170/71	68	70	195	300	9	3.75 x 75	11	3.75 x 30	6.8	6.3	6.3	2.4	5.7	5.7	2.8	2.6	2.6	3.2	3	3	1.2	2.9	2.9
LSSU170/75	70	72	195	300	9	3.75 x 75	11	3.75 x 30	-	6.3	6.3	-	5.7	5.7	-	2.6	2.6	-	3	3	-	2.9	2.9
LSSU275/75	70	72	300	400	15	3.75 x 75	11	3.75 x 30	-	10.8	10.8	-	5.7	5.7	-	4.5	4.5	-	5.1	5.1	-	2.9	2.9
LSSU170/96	-	2x47	195	300	9	3.75 x 75	11	3.75 x 30	-	6.3	6.3	-	5.7	5.7	-	2.6	2.6	-	3	3	-	2.9	2.9
LSSU275/96	-	2x47	300	450	15	3.75 x 75	11	3.75 x 30	-	10.8	10.8	-	5.7	5.7	-	4.5	4.5	-	5.1	5.1	-	2.9	2.9
LSSU170/100	95	97	195	300	9	3.75 x 75	11	3.75 x 30	-	4.7	4.7	-	5.7	5.7	-	2	2	-	2.2	2.2	-	2.9	2.9
LSSU275/100	95	97	300	400	15	3.75 x 75	11	3.75 x 30	-	8.2	8.2	-	5.7	5.7	-	3.4	3.4	-	3.9	3.9	-	2.9	2.9
LSU4.12*	-	2x51	241	356	24	4.0 x 100	12	3.75 x 30	7.2	-	-	3	-	-	3	-	-	3.4	-	-	1.5	-	-

INSTALLATION

Fixing

Oround holes allow skewed nailing if necessary.

The base must be blocked for a sloped configuration (principal rafter).

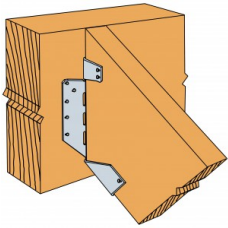

Sloped connection.

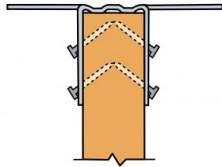

LSSU Installation

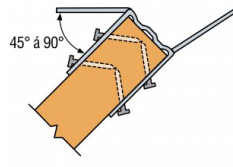

LSSU Installation

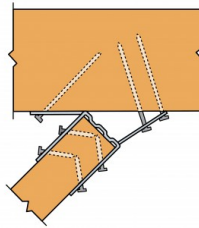

LSSU Installation